



UP & DOWN

TV20VMB

20 MM VENETIAN BLIND





design your sunlight

Innovation, design, quality. These are the values on which, for the last thirty years, the world of Sunbell has firmly founded its business by developing cutting-edge solutions that are strictly Made in Italy for managing the lighting levels of any environment. Exclusive technical double-glazing blind systems combined with cutting-edge solutions applied to the products outside the glass, enable lighting levels to be adjusted as required for each and every situation, creating the perfect ambience. Linear design, research into materials and fabrics and the study of increasingly innovative products with European patents combine seamlessly with the craftsmanship that is put into creating each and every product, which constitute a unique symbol of superior Italian quality throughout the world. Sunbell's blinds are elegant furnishing accessories that can be used to create the perfect level of lighting required; villas and apartments, offices and retail space, residences and hotels, hospitals and health care facilities, schools and public buildings are just some of the places in which Sunbell products can be used.

Flexibility and a personalised, customer-oriented focus complete the profile of an innovative company with strong roots, which looks towards the future, guaranteeing the quality of each and every product and ensuring excellent results.





UP&DOWN

The first and only European-patented rechargeable battery-operated system with wireless magnetic actuator and electronics outside the glass unit, Up & Down is the perfect fusion of design and functionality. Pleasing to the eye, it does not require an electrical system and can be applied to any thickness of glass. The lithium batteries ensure increased duration compared to those currently available on the market. It is also possible to fit an internal or external photovoltaic panel to the glass to assist with recharging.

Exclusively designed to satisfy the needs of the British market, The New 20 mm blind is ideal for renovation of existing windows.

SLATS COLORS

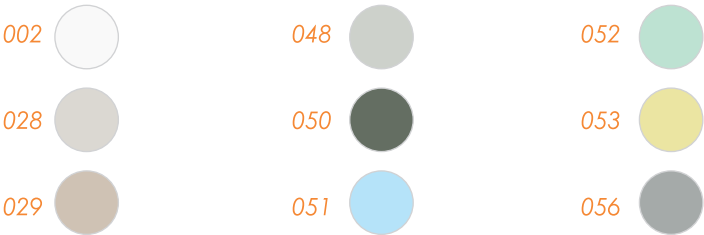

*available colors

BATTERY ACTUATOR COLORS



TV20VMB 20 MM VENETIAN BLIND

Venetian blind- rechargeable battery operated

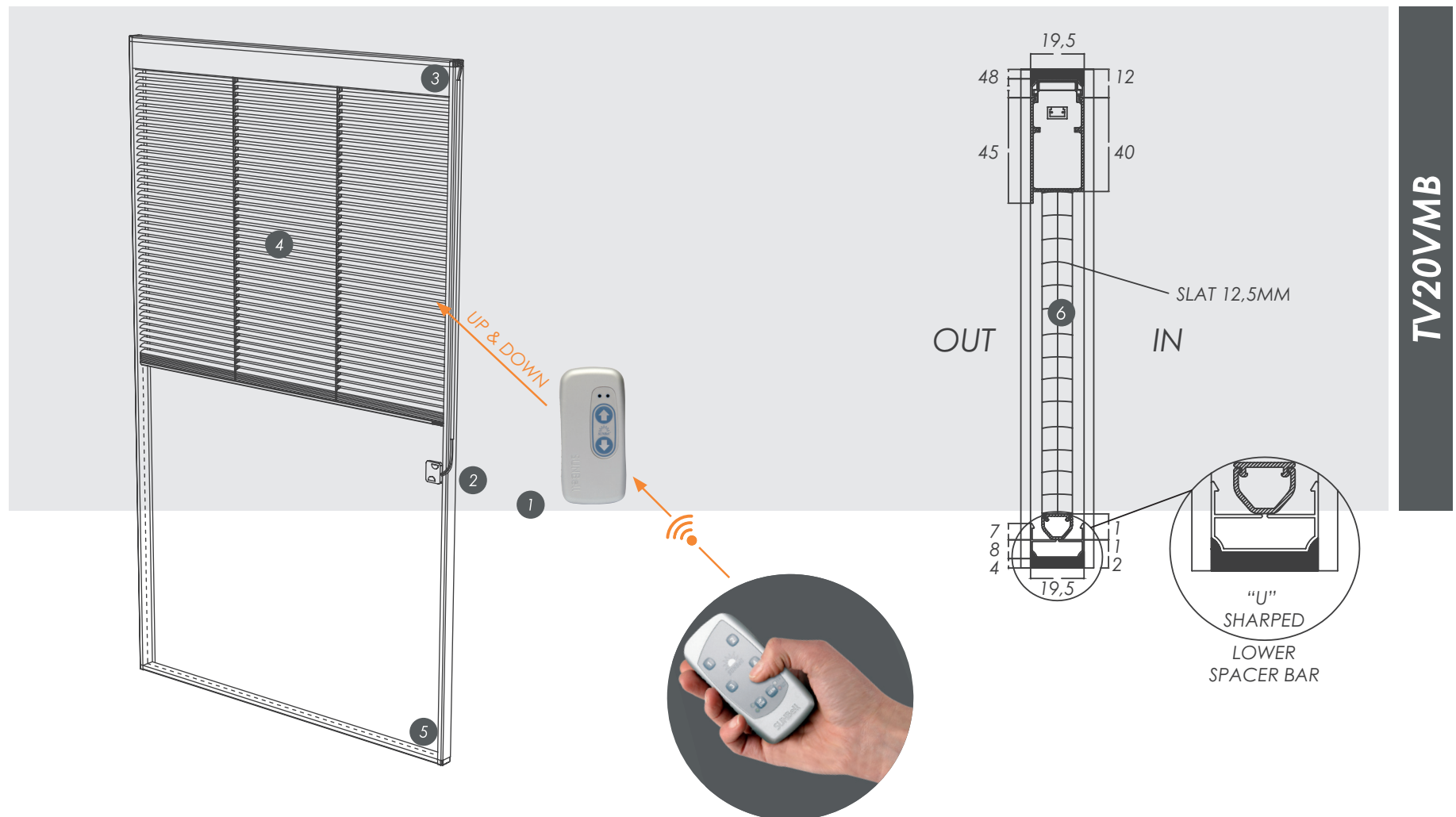

TECHNICAL INFORMATION FOR MODEL TV20VMB

1 BATTERY ACTUATOR

Wireless magnetic actuator with rechargeable lithium batteries and electronics for blind movement management. Available in silver, white and black and in the version with radio receiver.

2 WIRING WITH MAGNETIC CONNECTOR

100, 150 and 200 cm long cable for connection to the blind. Magnetic connector dimensions 25 x 30 x 5 mm depth with two tapered holes for fixing to frame and biadhesive for sticking to glass.

3 MOTOR

Motoreductor placed in a special support inside the head rail and controlled by a 12V motor managed by the actuator. No electronics inside the IG unit.

4 ALUMINIUM SLATS

Slats dimensions 12,5 mm width x 0.21 mm thick. Suitable for uses requiring NO FOGGING properties. Available in 9 colors. All tests on slats are performed in accordance with EN standards.

5 EXTRUDED ALUMINIUM PROFILES

20 mm depth spacer bars in extruded aluminium: side bars are L-shaped and low bar is U-shaped. Head rail dimensions 19.5 mm depth x 40 mm high / 45 mm high (backside with flap). Bottom rail dimensions 12.6 mm depth x 11 mm high. Both head and bottom rail colors are matched with slats.

6 CORDS AND LADDERSTRINGS

Composition: 100% polyester.

TV20VMB 20 MM VENETIAN BLIND

[illegible]

Available measurements are shown with the color highlighted.

Visit our website www.Sunbell.it
and download our tablet app from the App Store or Google Play
Follow us on Facebook/SunbellWorld



Via I Maggio, 44/46 25038 Rovato BS - TEL +39 030 7704635 - FAX +39 030 7704607
www.sunbell.it